



## Safety Considerations

This product has been designed and manufactured with personal safety in mind. Failure to follow these instructions can result in bodily injury and serious damage to the product. Please read and observe all precautions provided herein.

Safety glasses should be worn at all times while performing the installation procedures. 

Disconnected optical connectors may emit radiation if the far end is coupled with a working laser or Light-Emitting Diode (LED). Do not view the fiber end of a cable or plug with an optical instrument until absolute verification is established that the fiber is disconnected from any laser or LED source. 

For cleaning optical fibers, use the recommended Fiber Optic Cleaning Solution (FPF-01) and Fiber Wipes (FW-01) or Isopropyl Alcohol (>91% 2-Propanol + water) with lint-free wipes.

If working in high places, please be careful not to drop any tools. Use a wrist-strap when possible.

## Kit Contents

Item	Description	Qty.
1	Connector w/ Wedge and Dust Cover	10
2	Connector Boot	10
3	Fiber Holder (900 µm)	1
4	Assembly Fixture	1

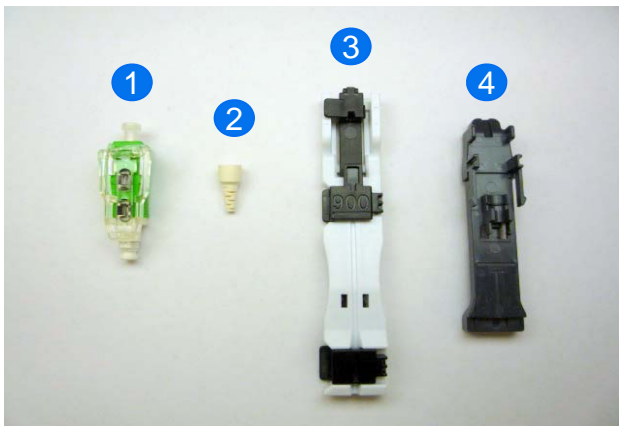

## Precautions

- Before using this product please read Safety Considerations.
- The connectors are very sensitive. Incorrect handling can cause damage and permanent degradation of performance. **Please read the instructions** given in this instruction manual.
- The product is sensitive to dirt or dust. Do not take connector out of the package **until it is ready to be used**.
- The cleaved fiber surface significantly affects the connector performance. Before operating the Optical Fiber Cleaver, ensure that it is equipped with a sharp blade.
- Great care must be exercised when inserting the cleaved fiber into the back of the connector. Please **insert the fiber into the connector slowly**. Failure to do so can result in small particles of shattered glass fibers.
- Do not remove the dust cap from the connector until the connector has been completely assembled.
- A specific volume of index matching gel is applied to the inside of the connector. For best performance avoid inserting the fiber more than once.
- Performance characteristics are referenced in OFS document: fap-149.

## Recommended Consumables

Item	Description	Comcode
1	Fiber Optic Cleaning Solution	FPF-01
2	Fiber Wipes	FW-01



## Required Assembly Tools

Item	Description	Comcode
1	Optical Fiber Cleaver	S325A
2	Fiber Optic Stripper	S211B



Feature	Stripping Function
1	1.6mm/2.0mm/3.0mm > 0.6mm/.9mm
2	0.6mm/0.9mm > 0.250mm
3	0.250mm > 0.125mm



① Preparing the connector

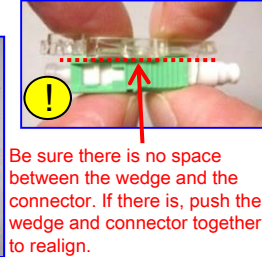

② Setting the connector

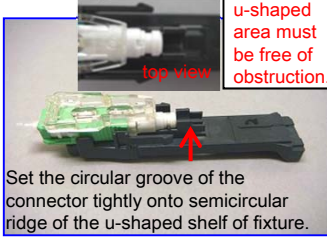

③ Preparing the fiber holder

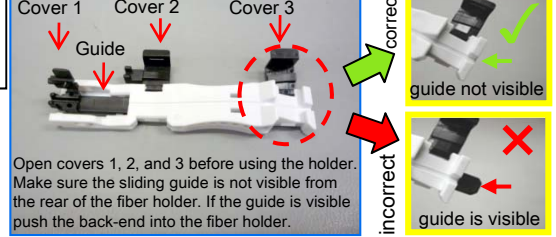

④ Install connector boot

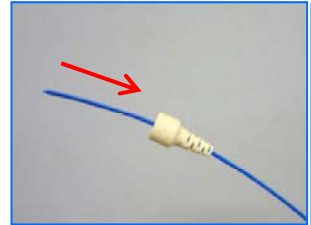

⑤ Remove fiber coatings

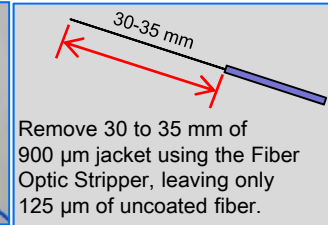

⑥ Clean the fiber

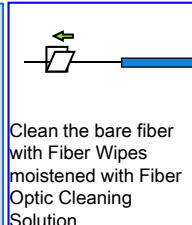

⑦ Screen the fiber

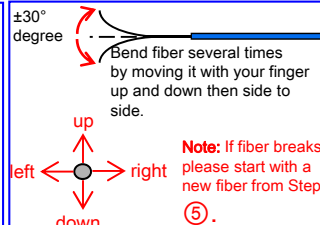

⑧ Set the fiber

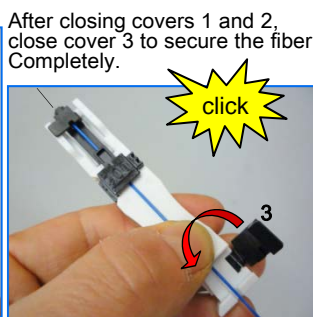
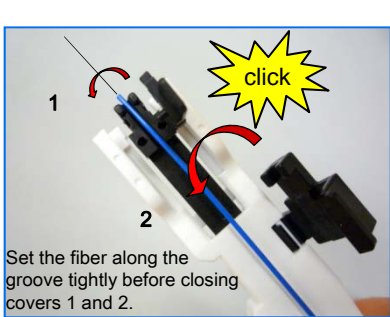
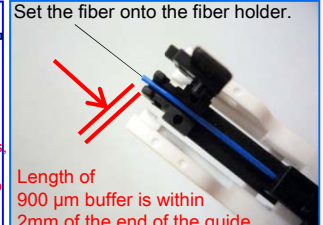

⑨ Cleave the fiber using the S325A

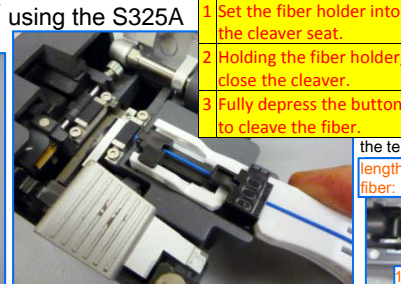

⑩ Fiber length check

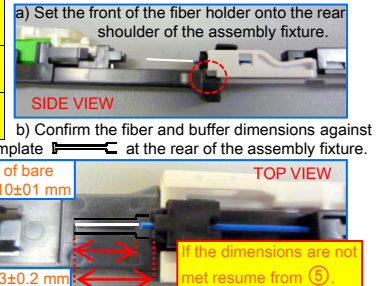

⑪ Inserting the fiber

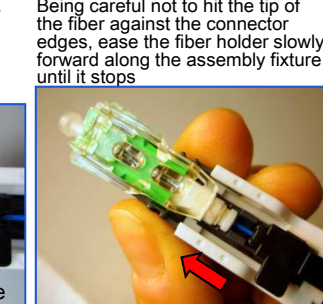
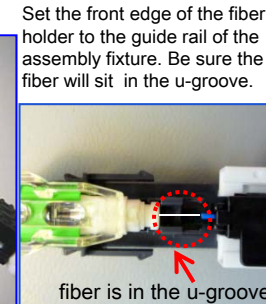
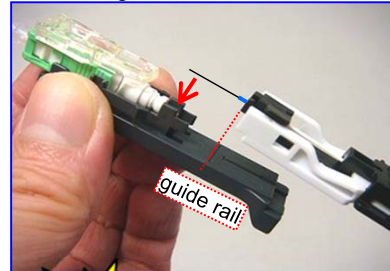

Open cover 2

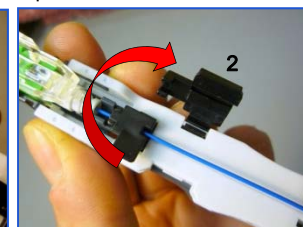

WARNING:

Failure to complete this step will result in an air gap between fibers creating high insertion loss.

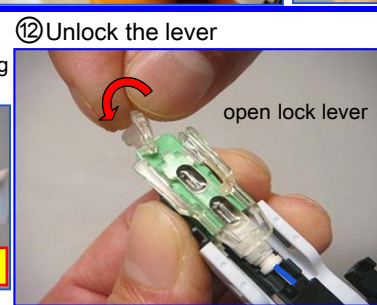
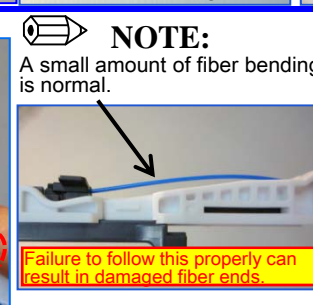
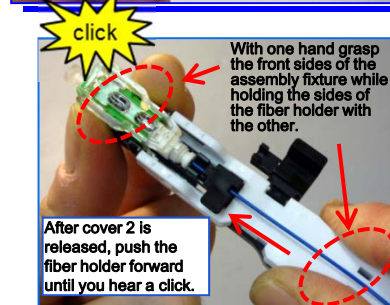

⑬ Remove the wedge

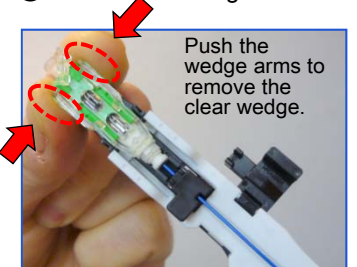

⑭ Open the cover

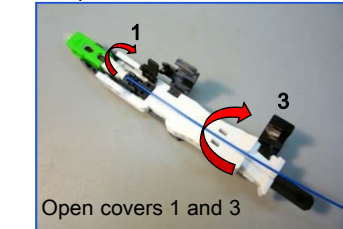

⑮ Remove the connector

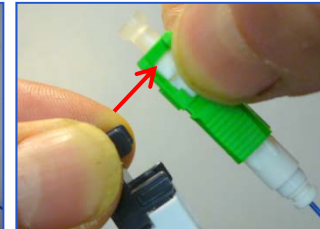

⑯ Fit the boot

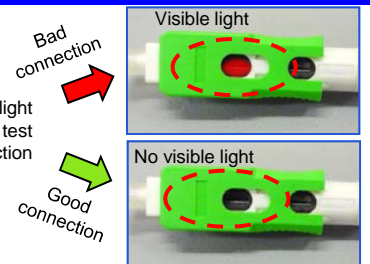
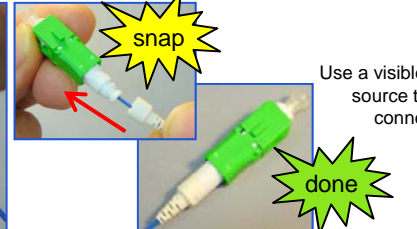

 **NOTE:**

If the connector performance does not meet the requirement you can adjust the connector by adjusting the fiber position.

① Align the wedge slots on the connector body with the wedge slots on the connector grip.

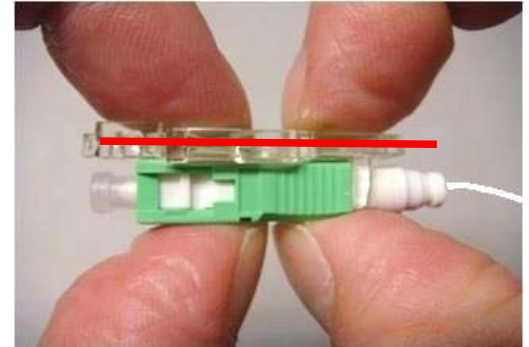
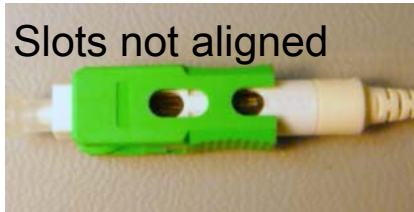

② Re-attach the clear wedge onto the connector. Ensure that there is no space between the wedge and the connector.

③ Gently push the inserted fiber and make the fiber bend again.

 **DANGER: DO NOT PULL THE FIBER OUT OF THE CONNECTOR**

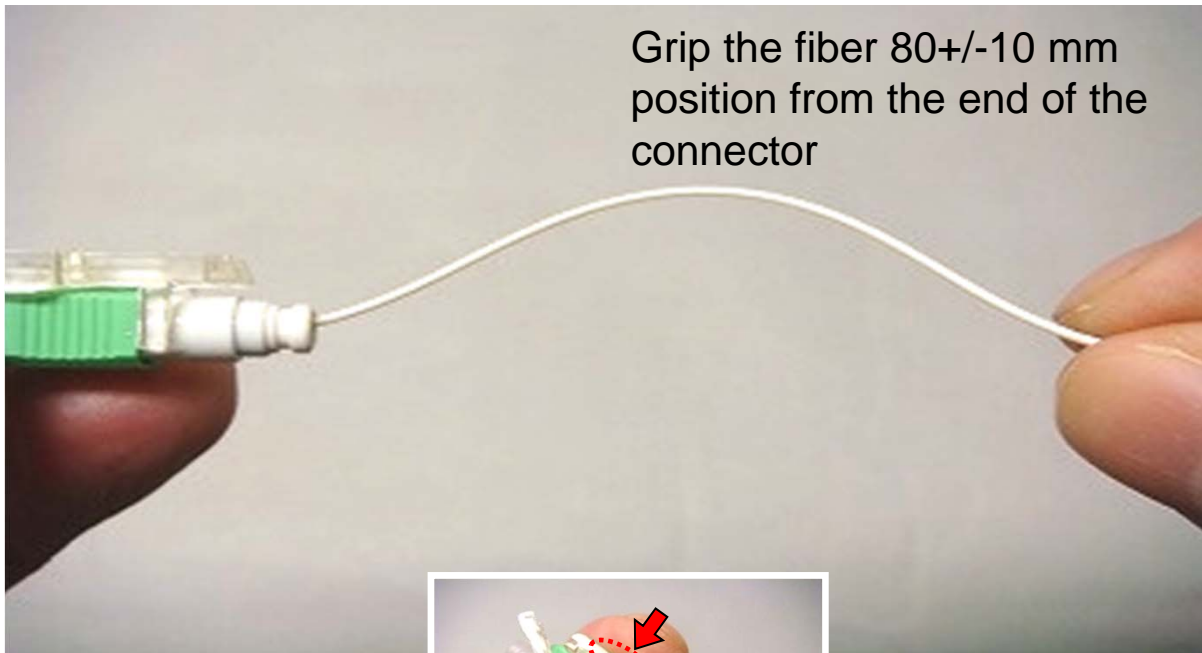

④ Remove the wedge

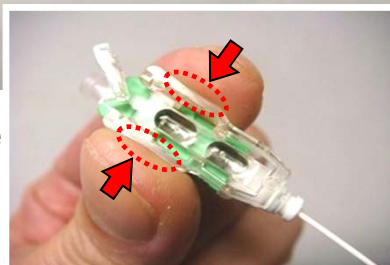

Push the wedge arms to remove the clear wedge.